

START A SHIFT - PREPARE BELT

1. Open belt

Release Velcro®
... and slide belt out of
buckle clip

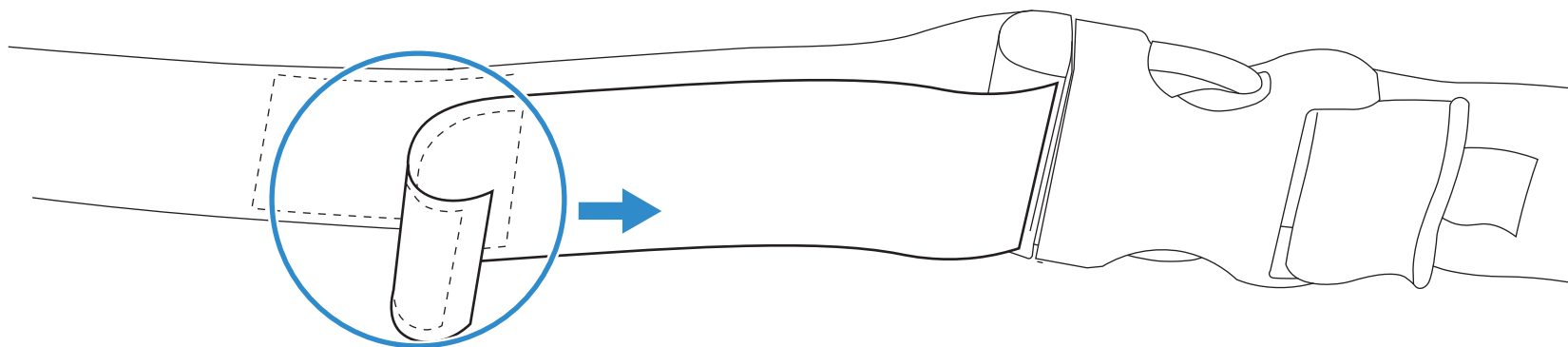

2. Slide the holster onto the belt

Talkman A730 holster
OR
Talkman A710 or A720 holster

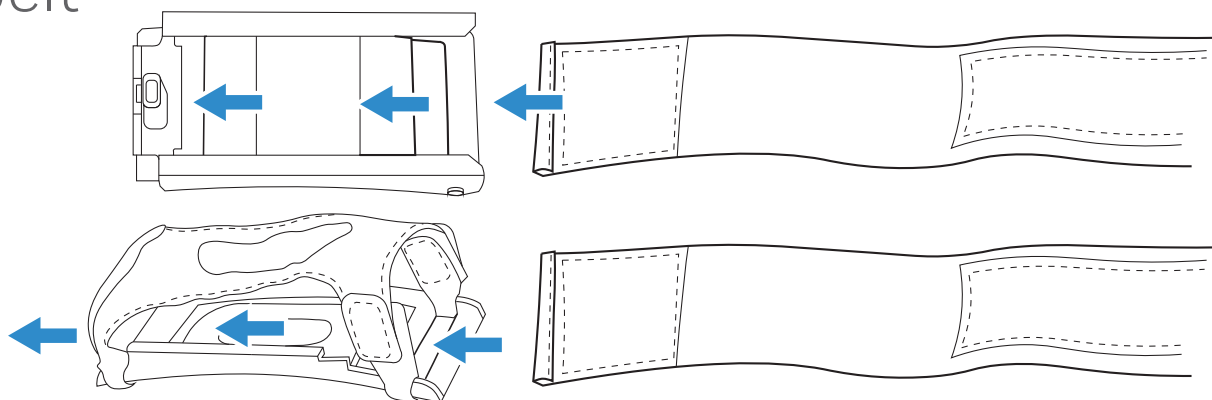

3. Close belt

Feed belt back through buckle
... and close Velcro®

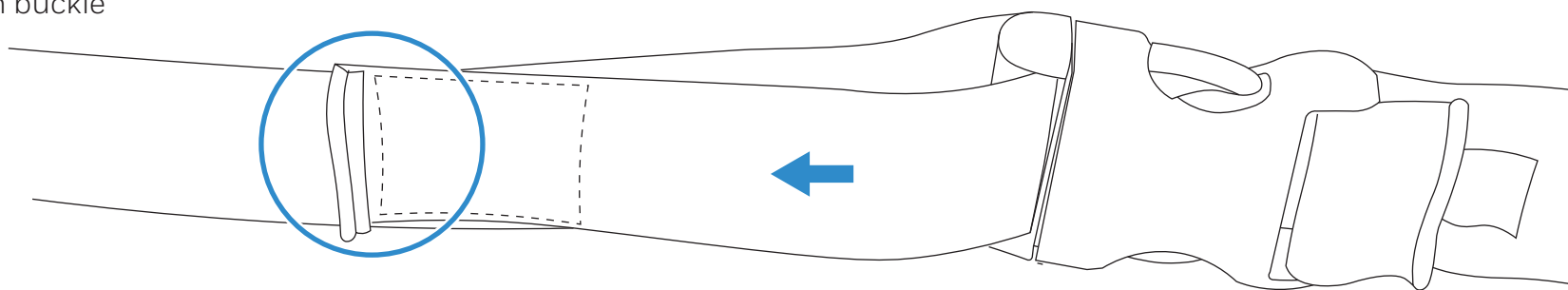

4. Put on belt

Release buckle,
wrap belt around waist
and click buckle ends together

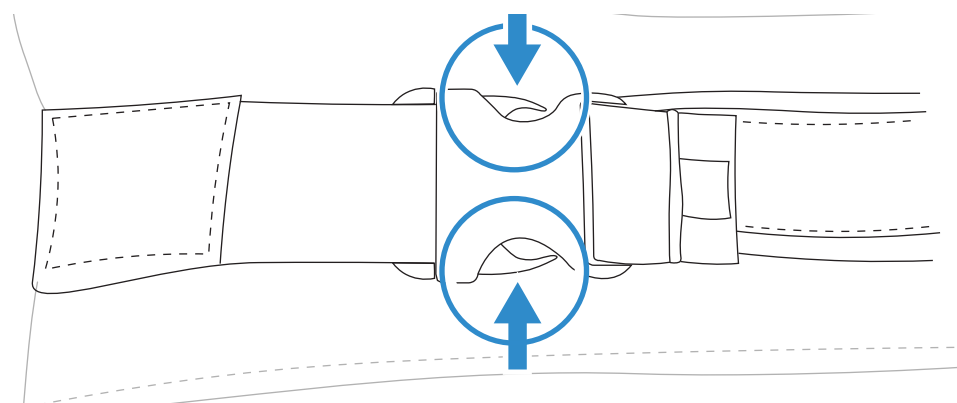

5. Slide device into holster

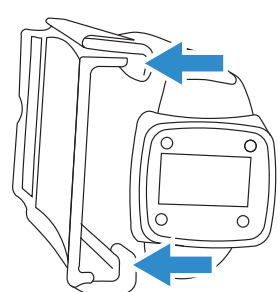

Talkman A730

Align device slot runners with
holster and slide until click

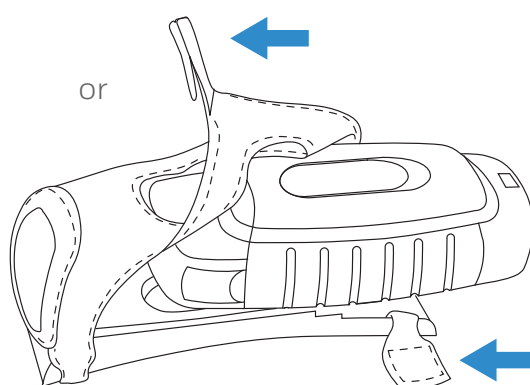

or

Talkman A710 or A720

Adjust Velcro,
slide in device
and fasten Velcro

START A SHIFT - WIRELESS HEADSET

6. Select device

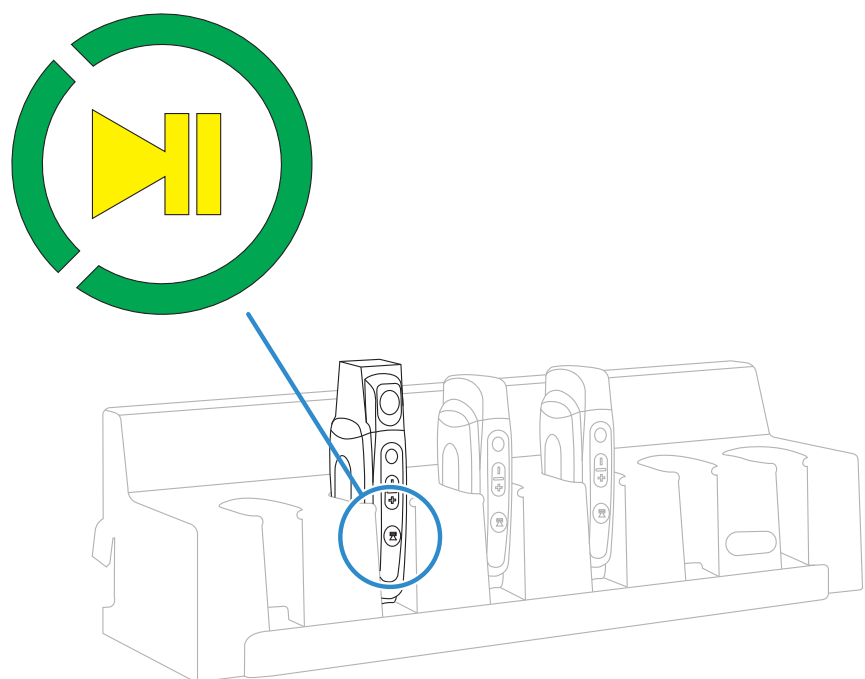

7. Power on SRX2

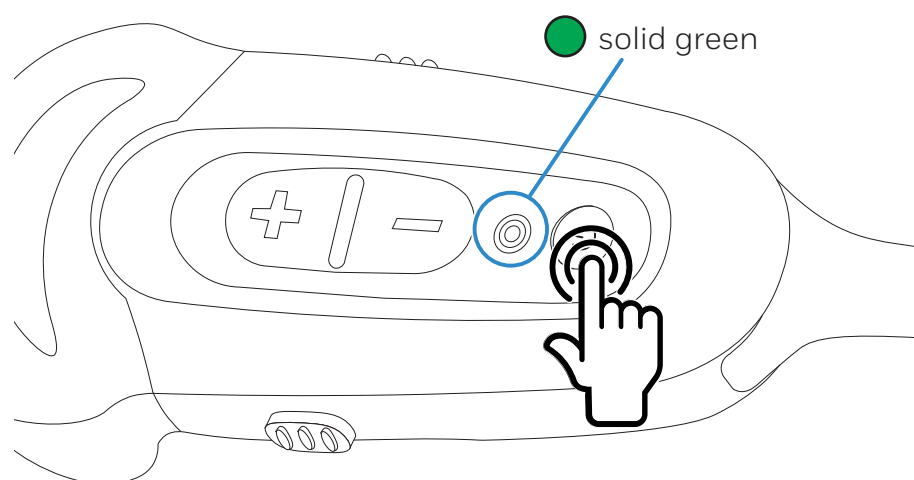

8. Touch electronic module to device at © symbol

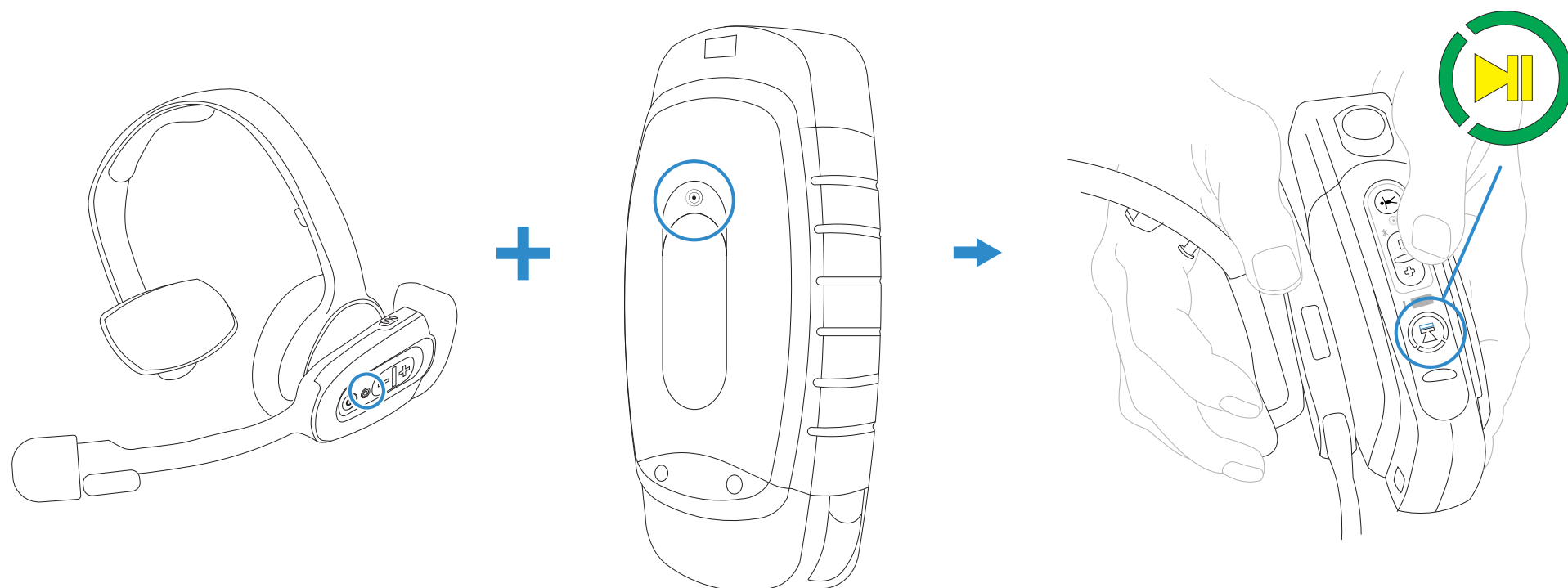

9. Put on headset and position microphone

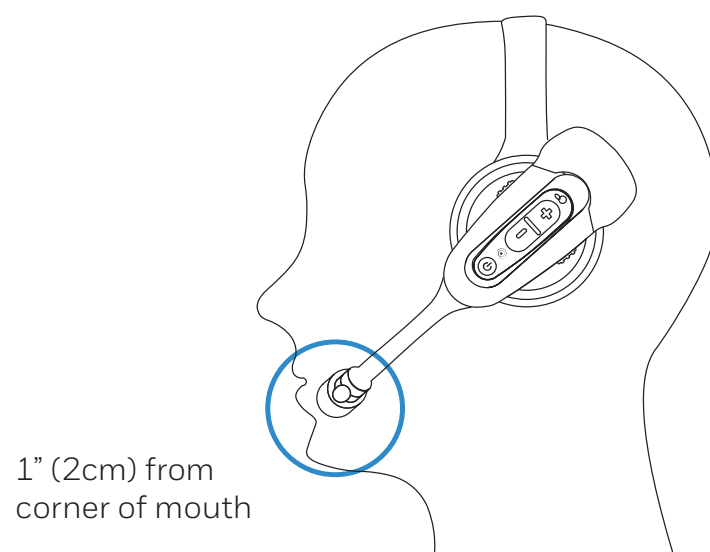
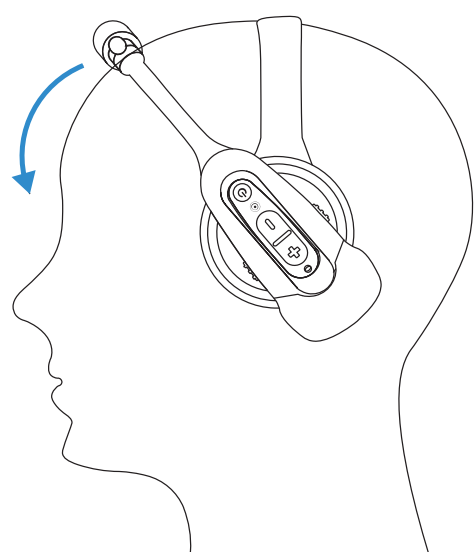

START A SHIFT - WIRELESS HEADSET

6. Select device

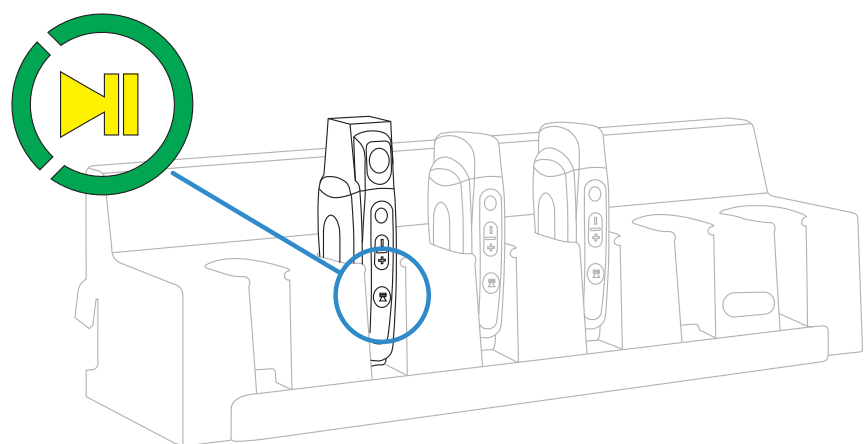

7. Power on SRX device

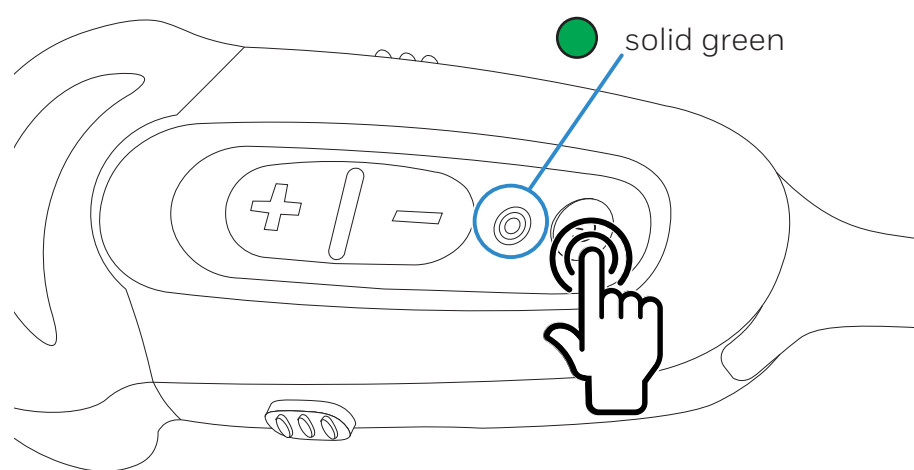

8. Touch headband to device at  symbol

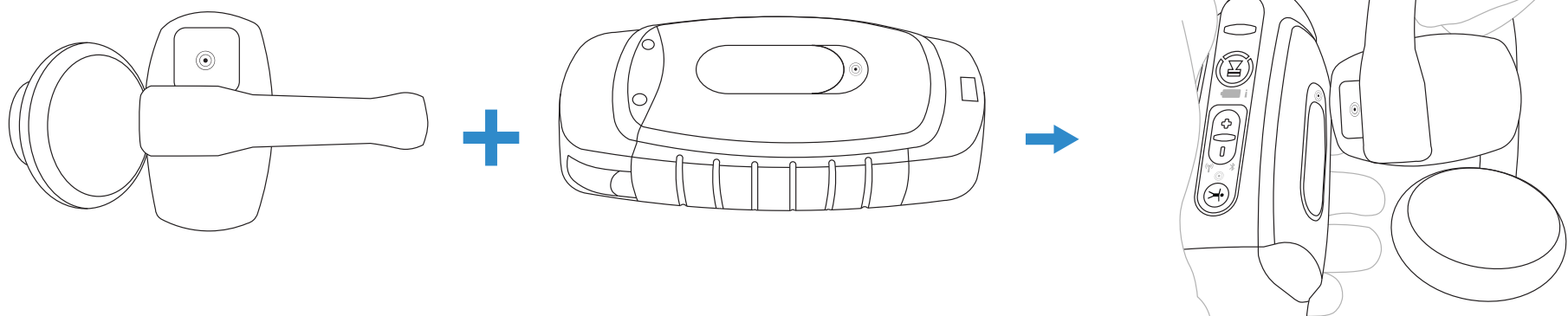

9. Touch electronic module to device at  symbol

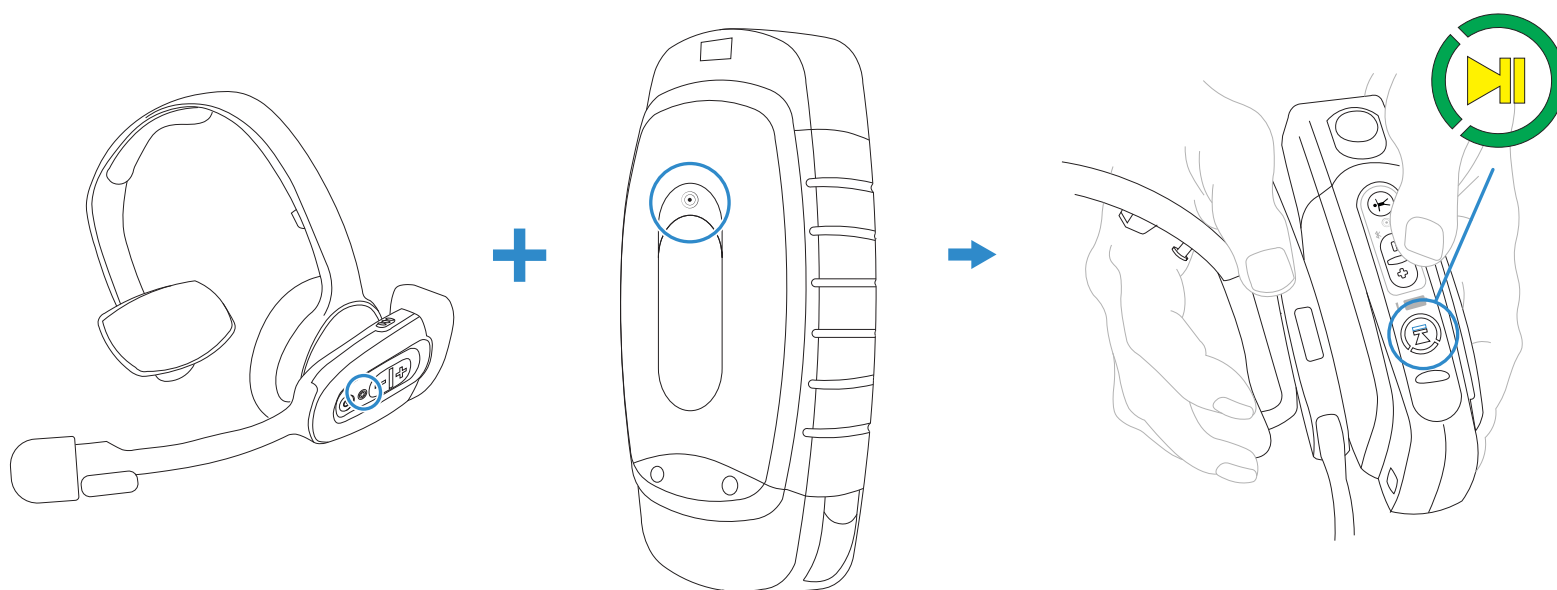

10. Put on headset and position microphone

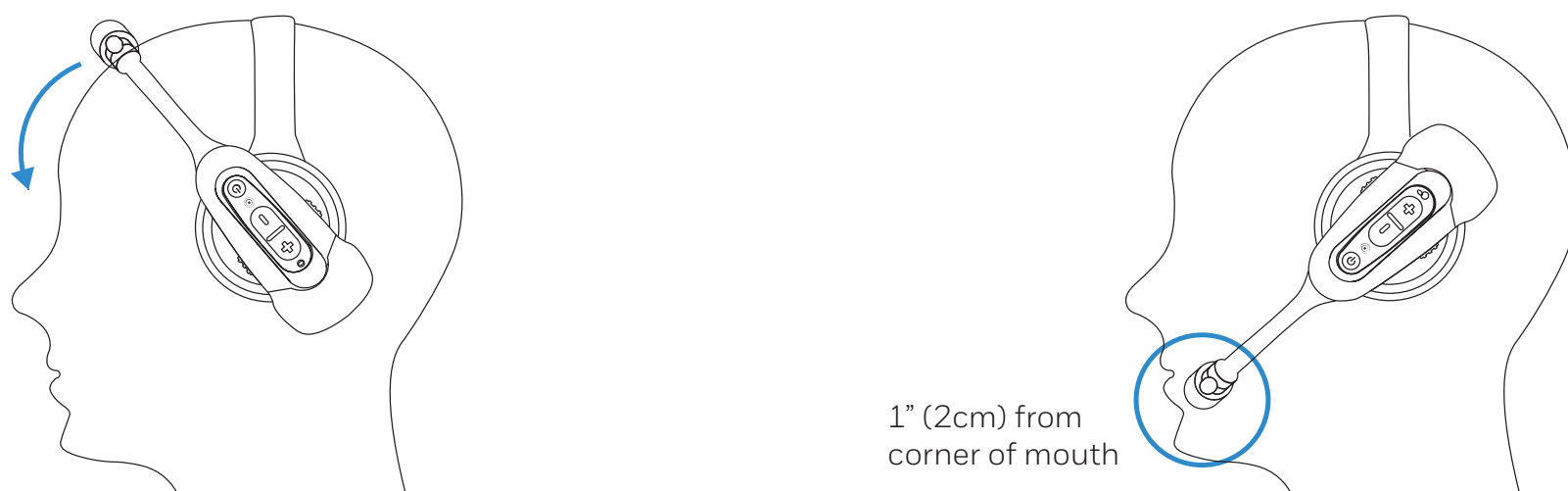

START A SHIFT - WIRED HEADSET

6. Select device

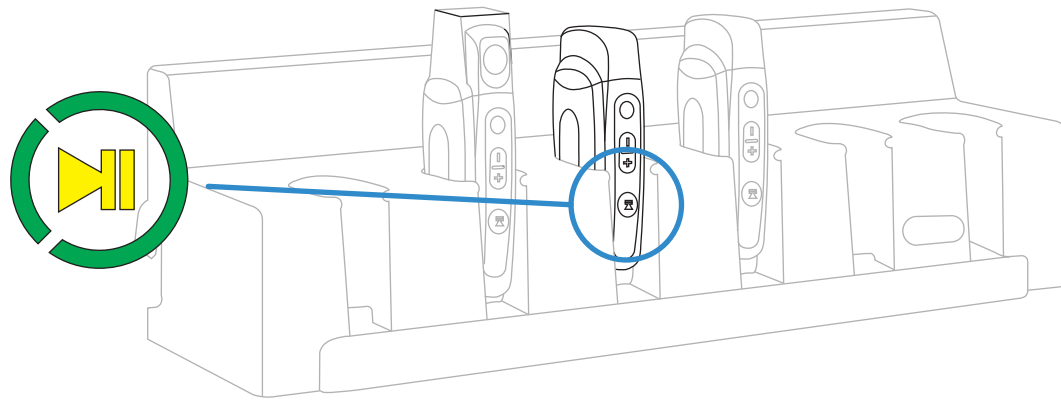

7. Put on headset and position microphone

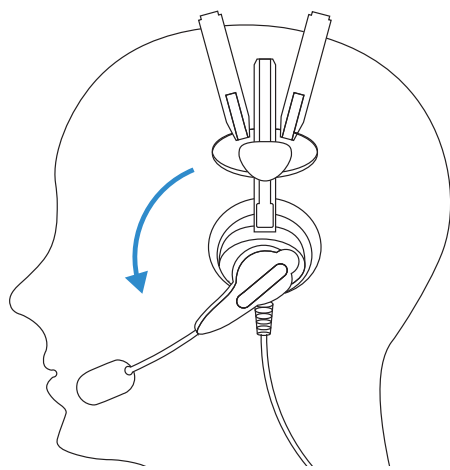

1" (2cm) from
corner of mouth

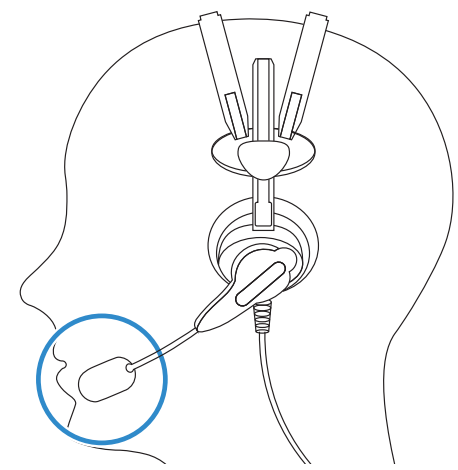

8. Fasten cable clips

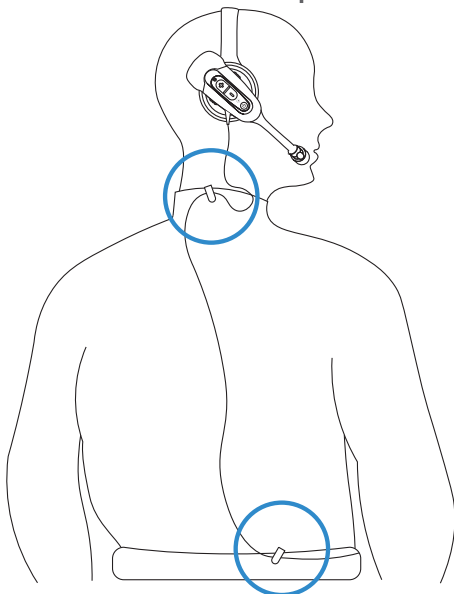

9. Match port colors

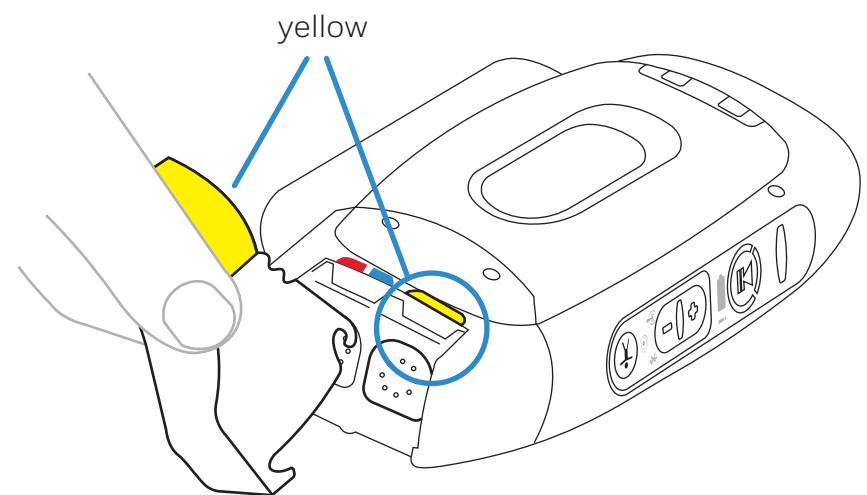

10. Tilt connector toward device until it clicks

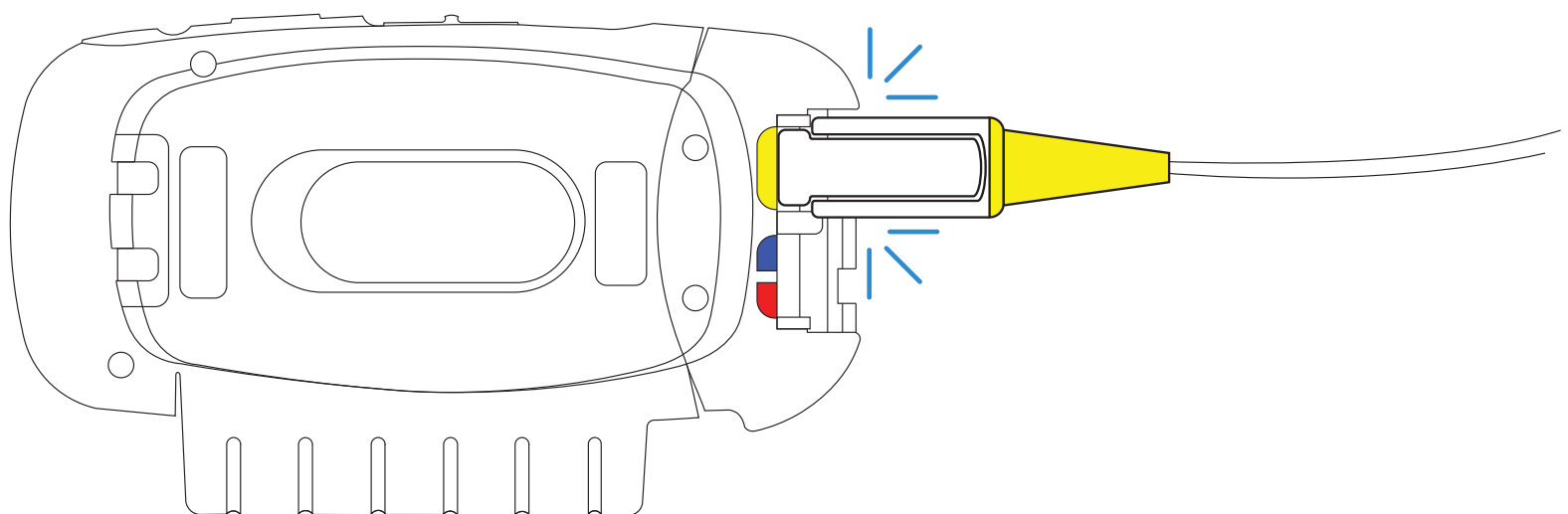

START A SHIFT - SIGN ON

11. Power on device

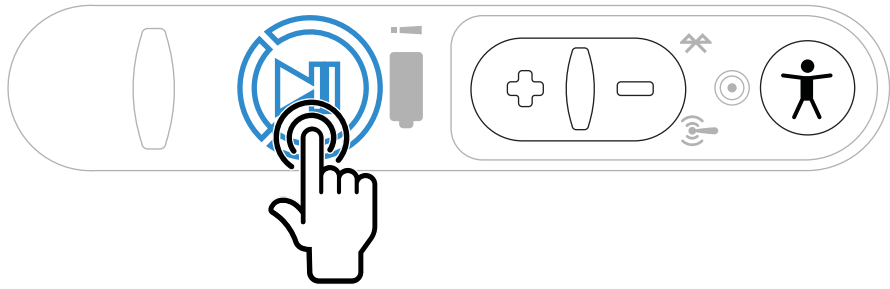

12. Press Operator

Confirm operator name

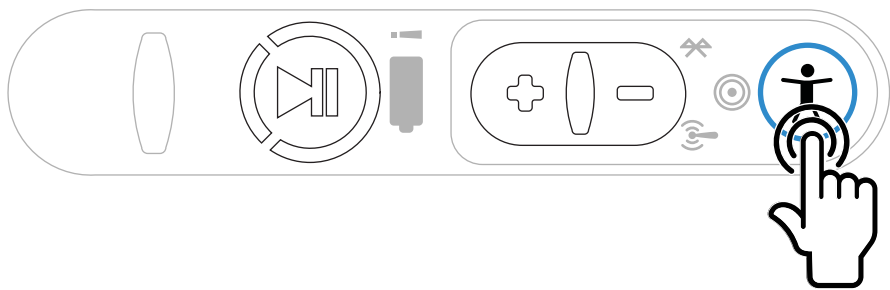

13. Press Play/Pause

Power on device

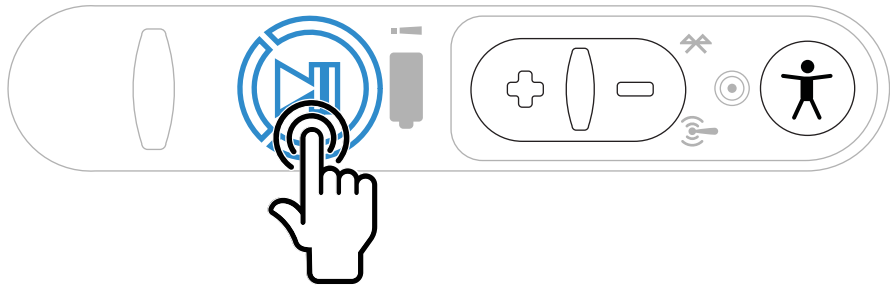

14. Do a noise sample

0, 1, 2, Ready.

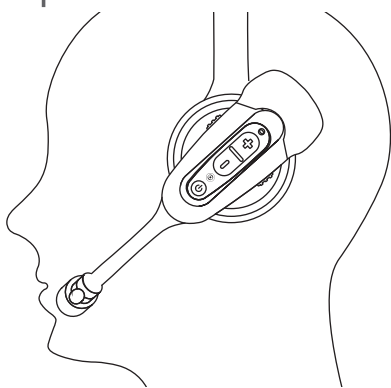

IF NEEDED. Change operator

Press Operator button



Press + or - until "Change Operator"

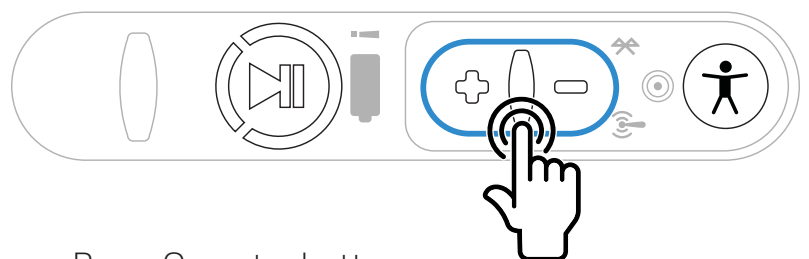

Press Operator button

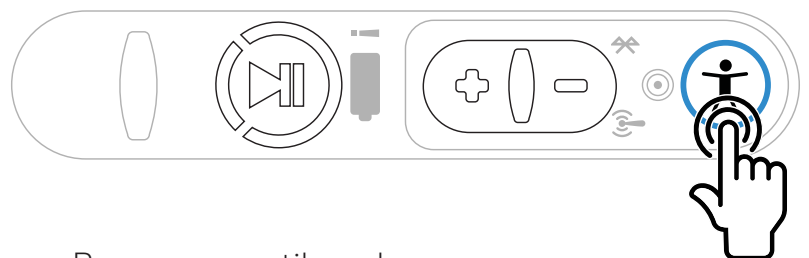

Press + or - until you hear your name

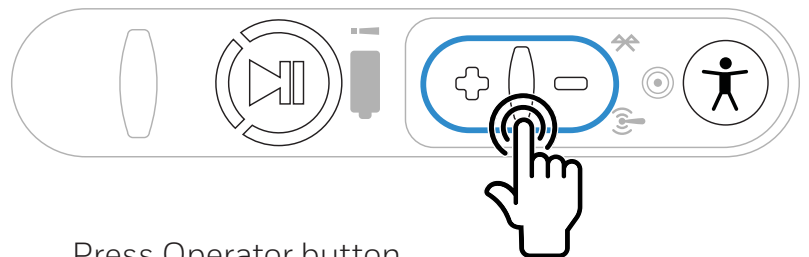

Press Operator button

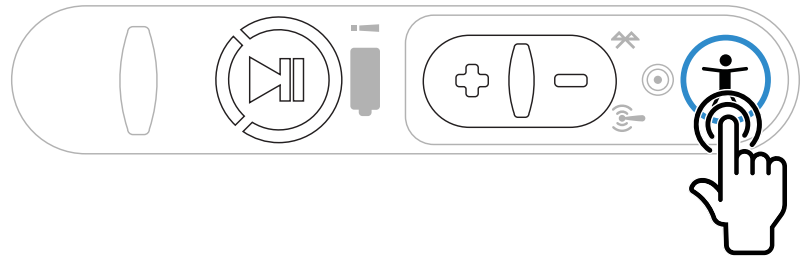

15. Confirm readiness

Ready.

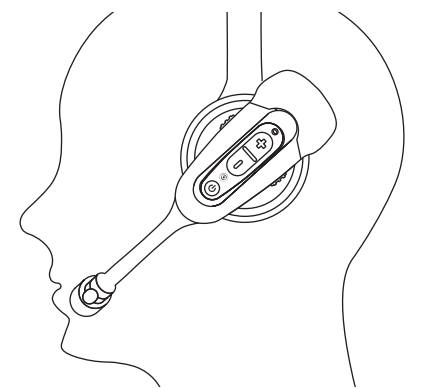

16. Say and confirm password

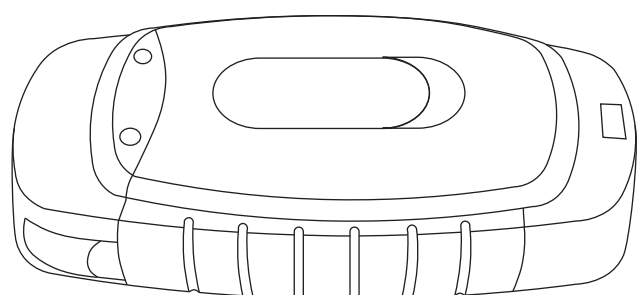

Password?

Correct?

Yes.

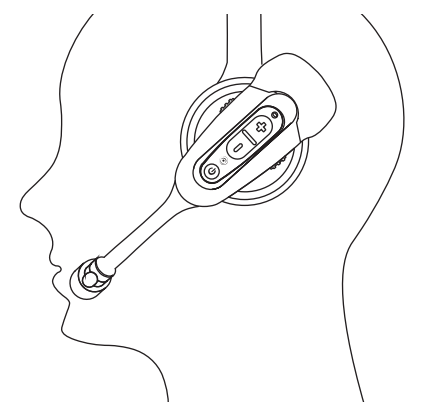

ADJUST FEATURES

TIP. Press the Play/Pause button at any time to cancel the action

1. Access the menu

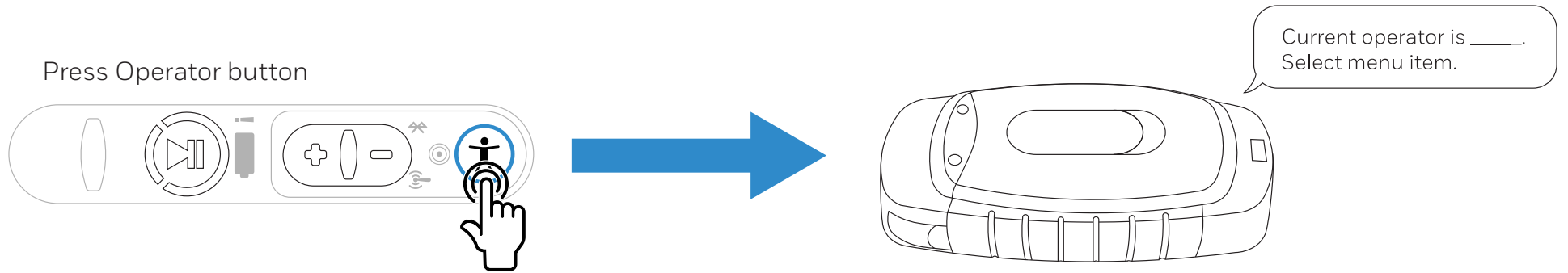

2. Press + or - button until desired menu item

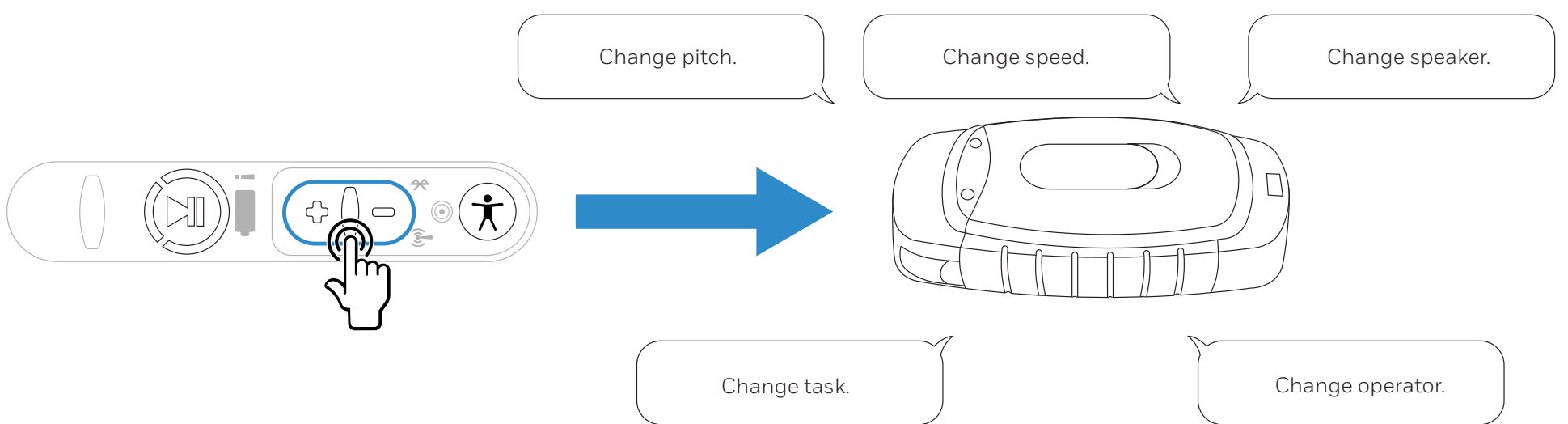

3. Press Operator button to select menu item

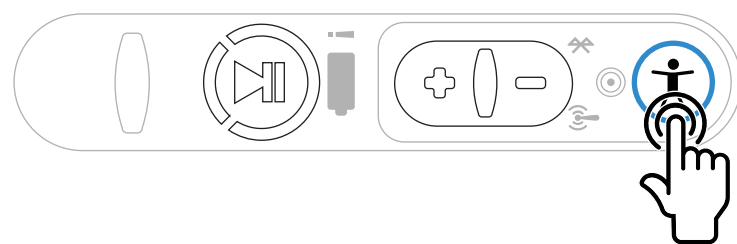

4. Press + or - button until feature is adjusted

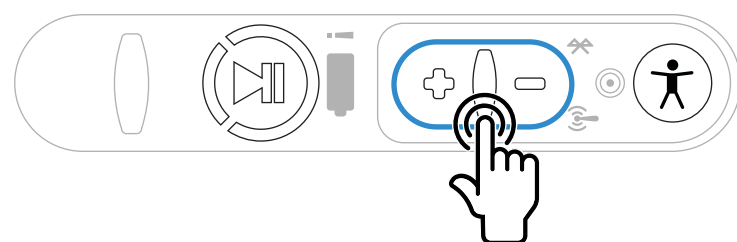

5. Press Operator button to confirm

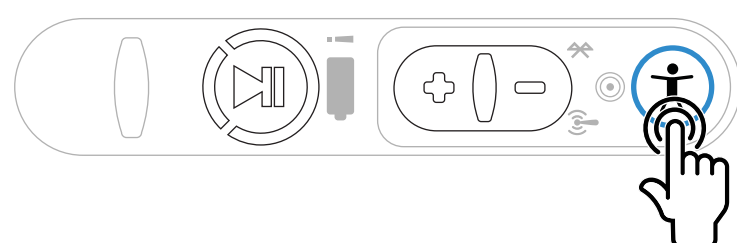

DEVICE STATE INDICATORS

1. Device state indicator - out of device charger

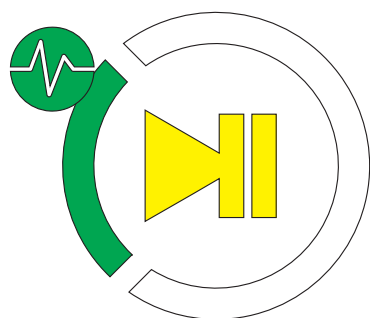

small segment
green & pulsing:
sleeping

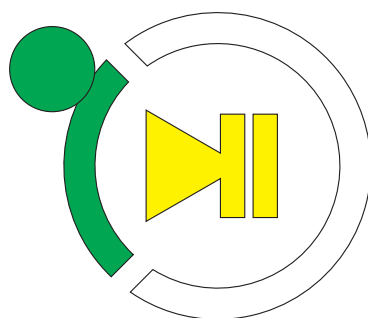

small segment
green & solid:
on

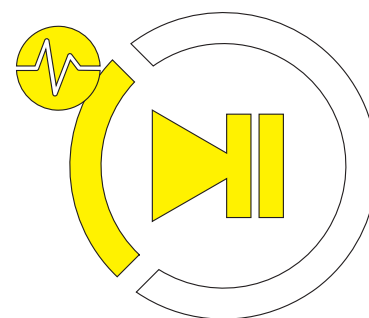

small segment
yellow & pulsing:
no task loaded

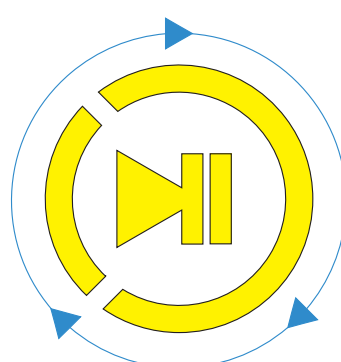
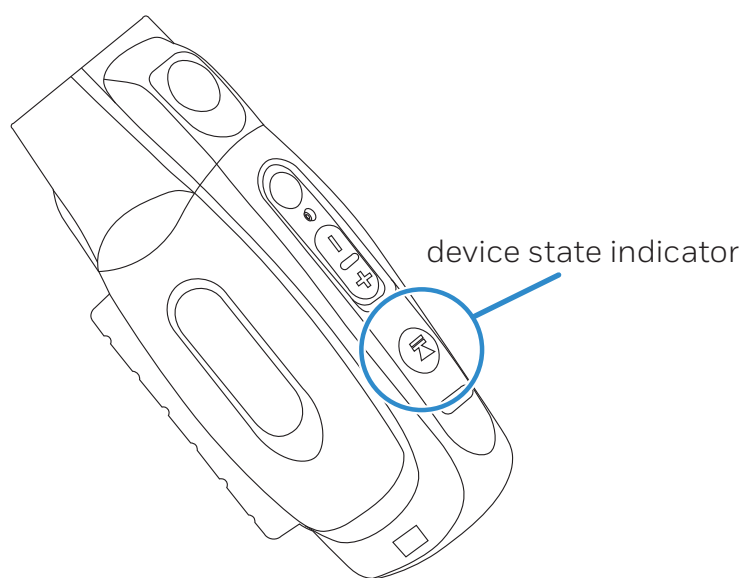

entire ring
yellow & rotating:
loading or starting

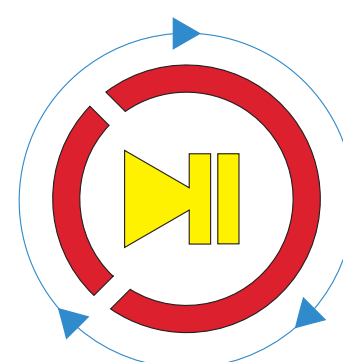

entire ring
red & rotating:
**loading software
or shutting down**

2. Device state indicator - in device charger

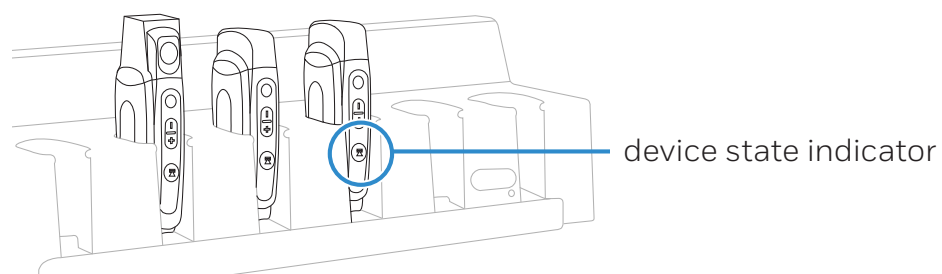

charging

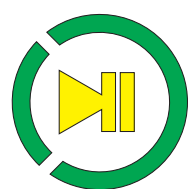

charging complete

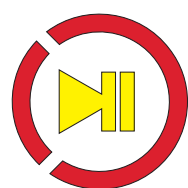

charging fault

3. TouchConfig™

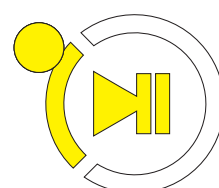
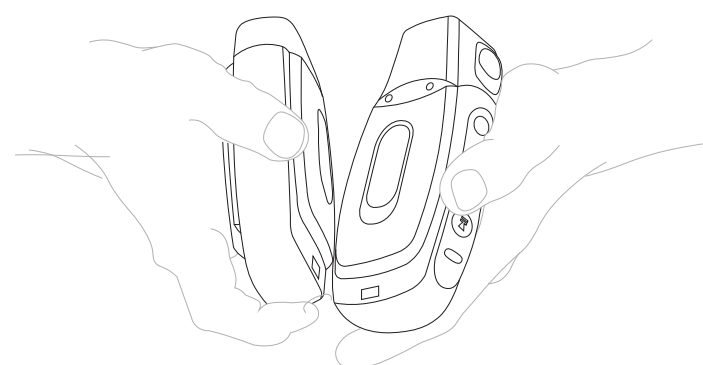

small segment yellow & solid:
sender mode

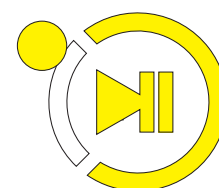

large segment yellow & solid:
receiver mode

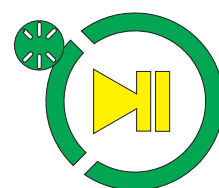

entire ring fast blink:
TouchConfig successful

CHANGE BATTERY

1. Slide battery release button away from battery

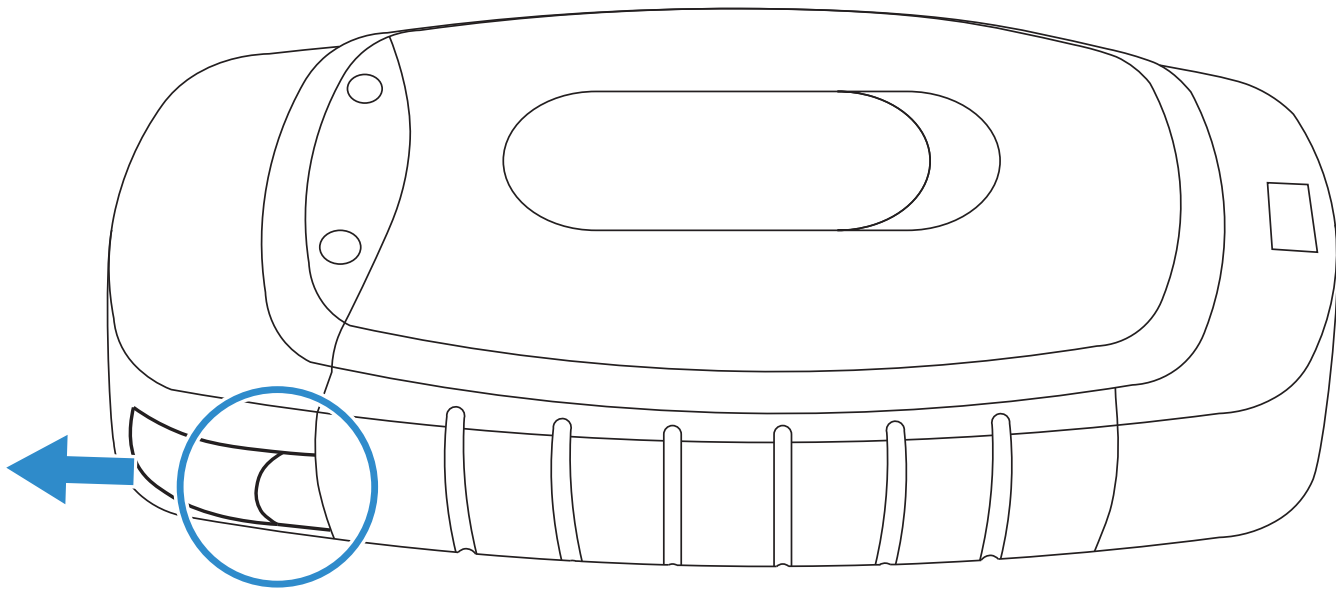

2. Lift out battery

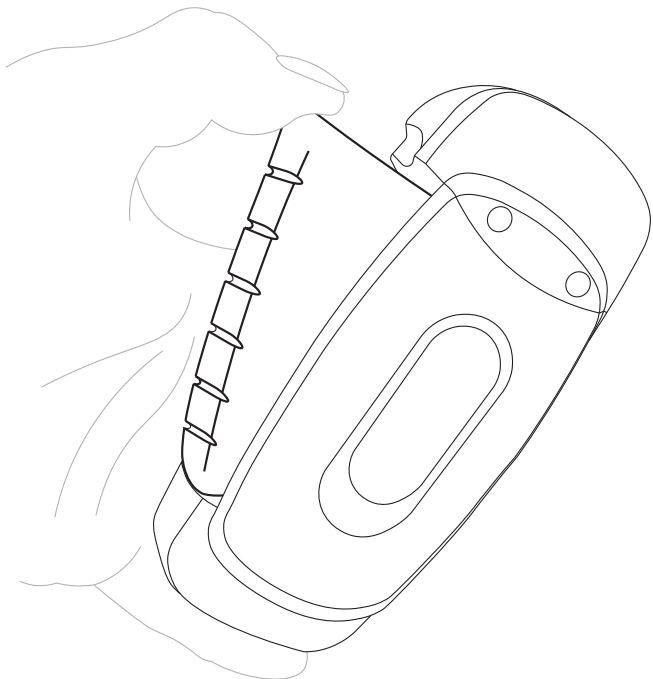

3. Place in empty slot

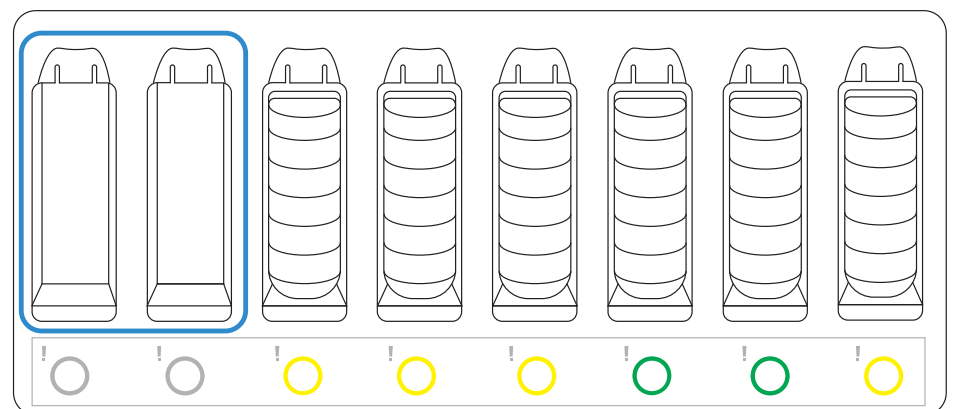

4. Pick charged battery

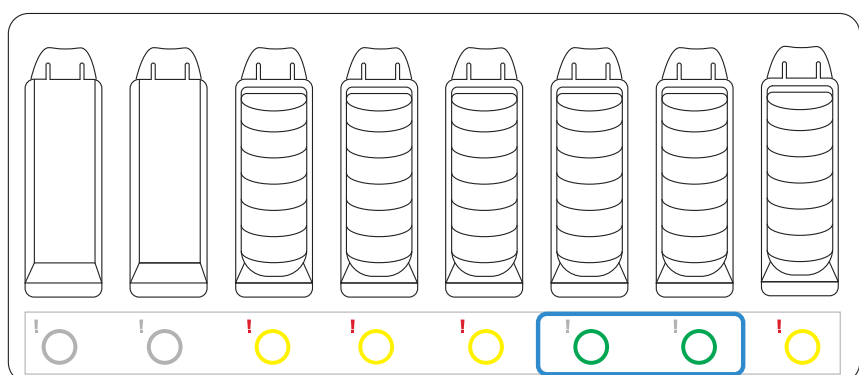

5. Insert pins-end first

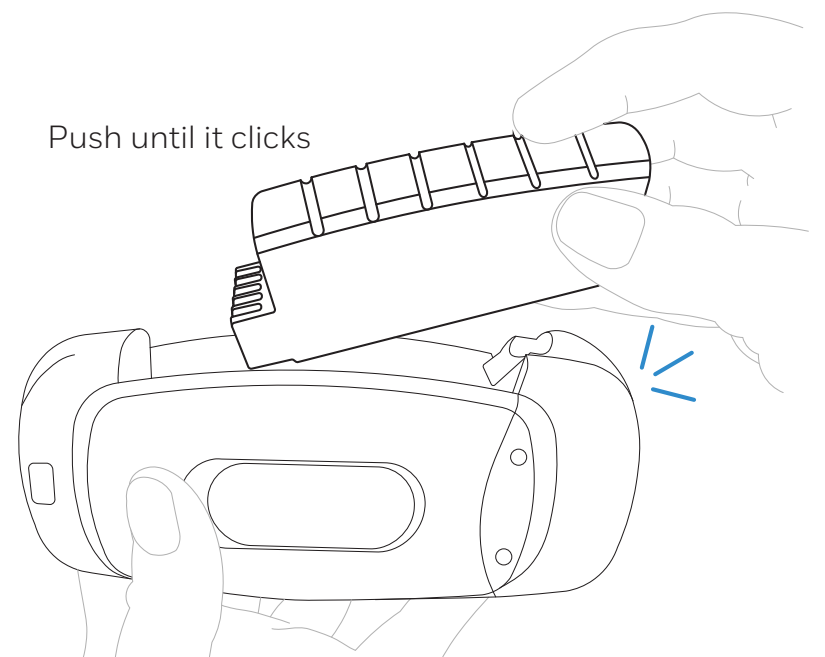

END A SHIFT - WIRED HEADSET

1. Power off device

Press and hold Play/Pause until LED rotates red

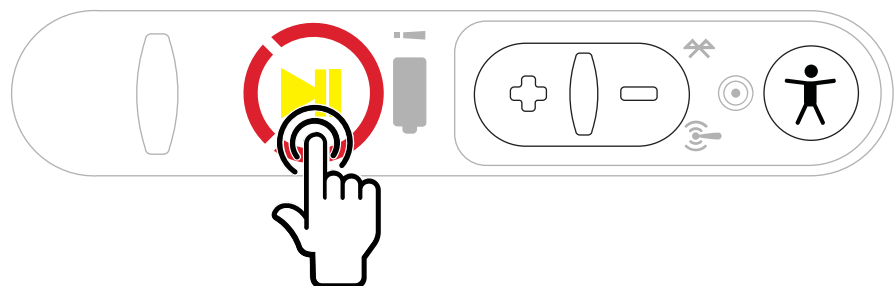

2. Remove connector

Grasp connector, tilt bottom of connector away from device and lift up

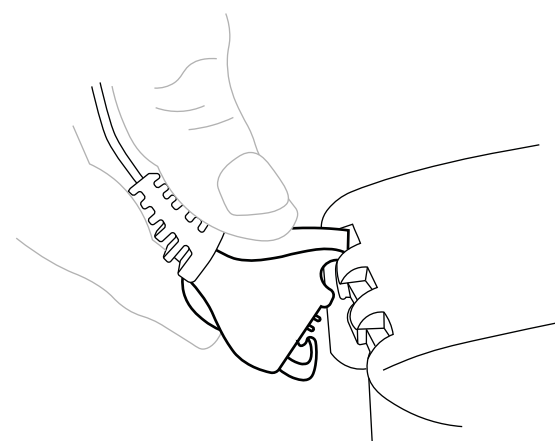

3. Slide out holster

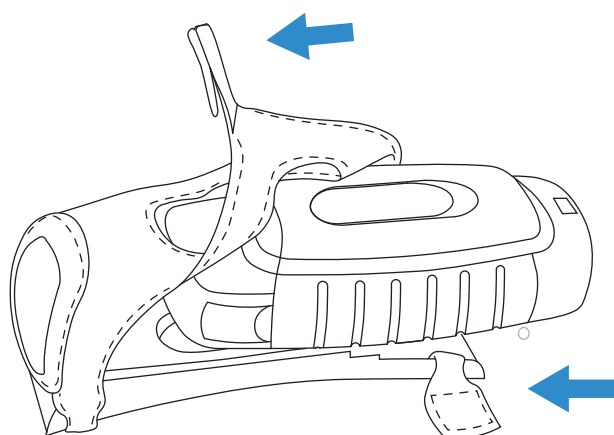

Open Velcro® and slide device out

4. Insert into slot

Insert device with button controls facing out and Operator button on top

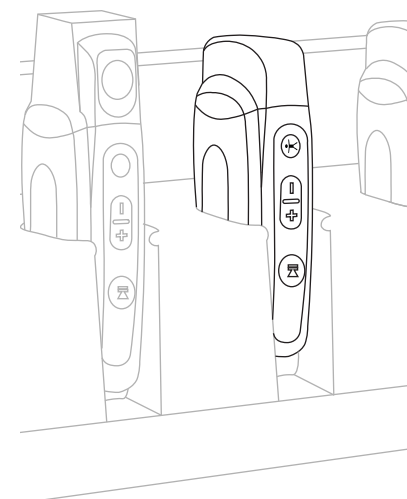

5. Detach cable clips

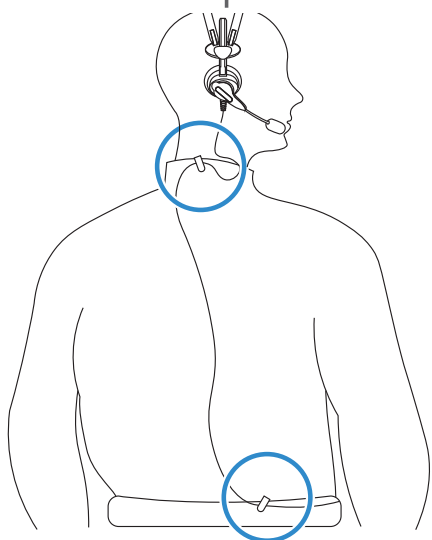

6. Remove headset

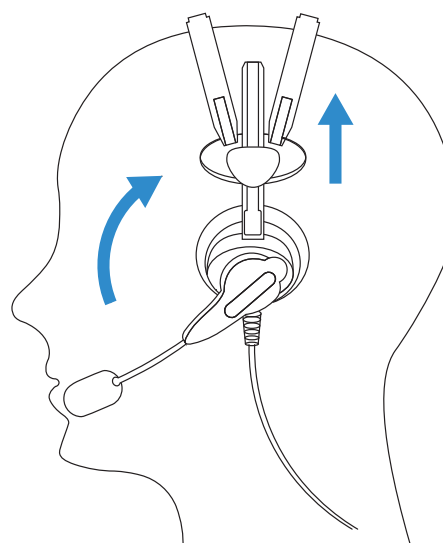

7. Remove belt

Release buckle

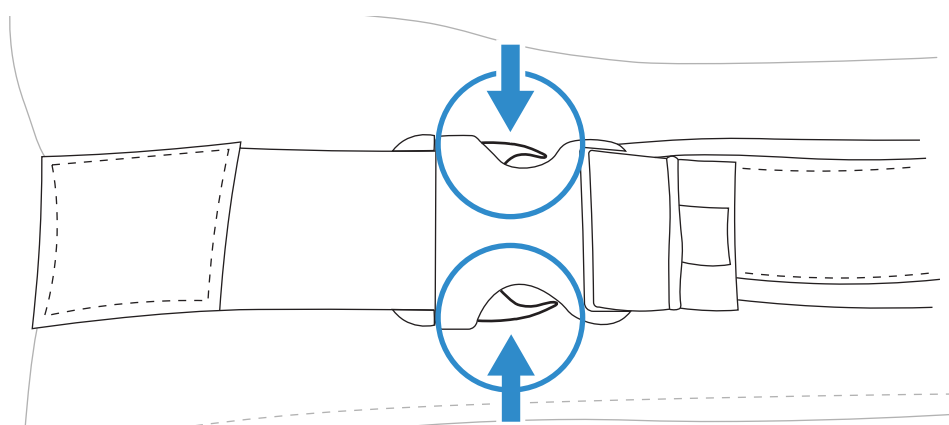

END A SHIFT - WIRELESS HEADSET

1. Power off device

Press and hold
Play/Pause until
LED rotates red

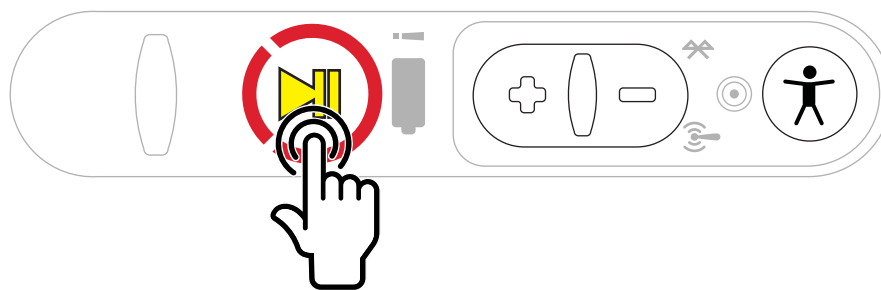

2. Slide device out of holster

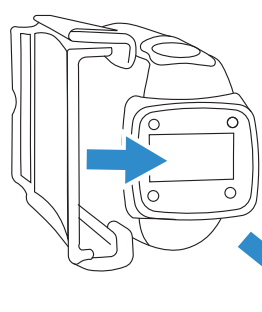

A730

Pull device away from
you, sliding along clip

or

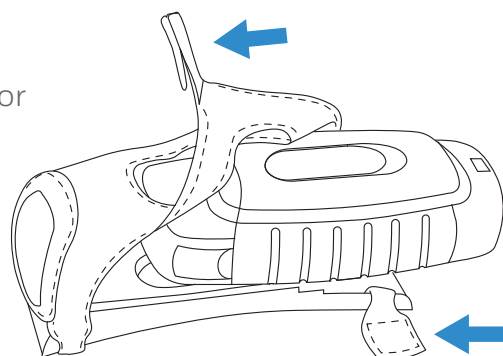

A710 or A720

Open Velcro® and slide
device out

3. Insert into slot

Insert device with button
controls facing out and
Operator button on top

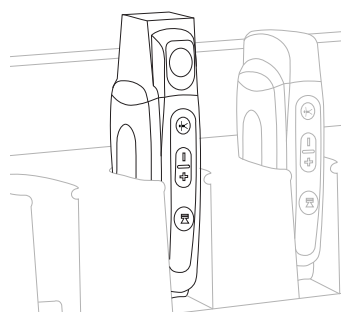

4. Power off headset

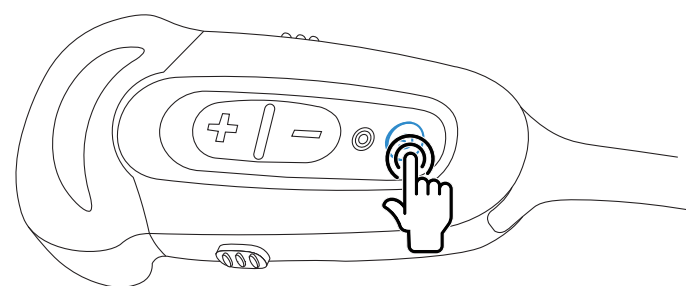

5. Remove battery

Squeeze battery
release buttons

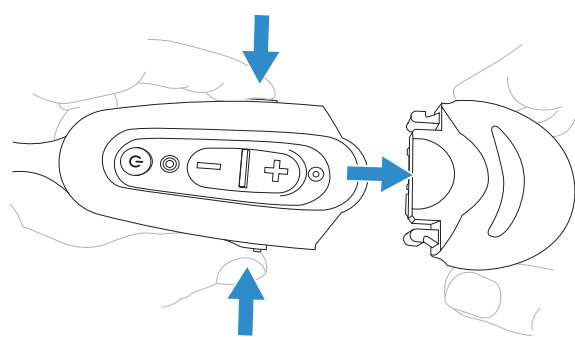

6. Place in charger

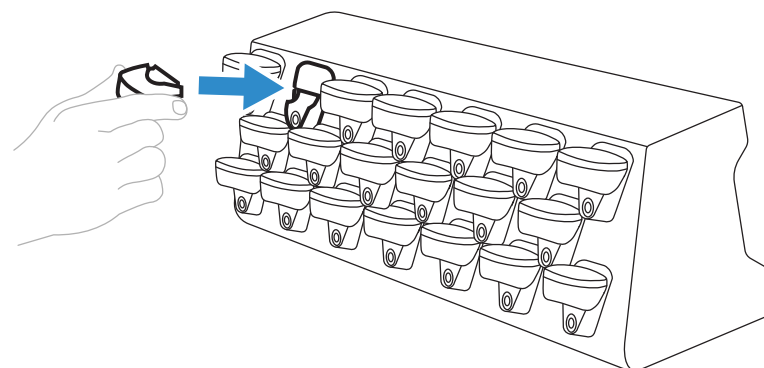

7. Remove belt

Release buckle

